

PENN TOWNSHIP SECTION 14 R 12 TWP 9 MORGAN COUNTY, OHIO

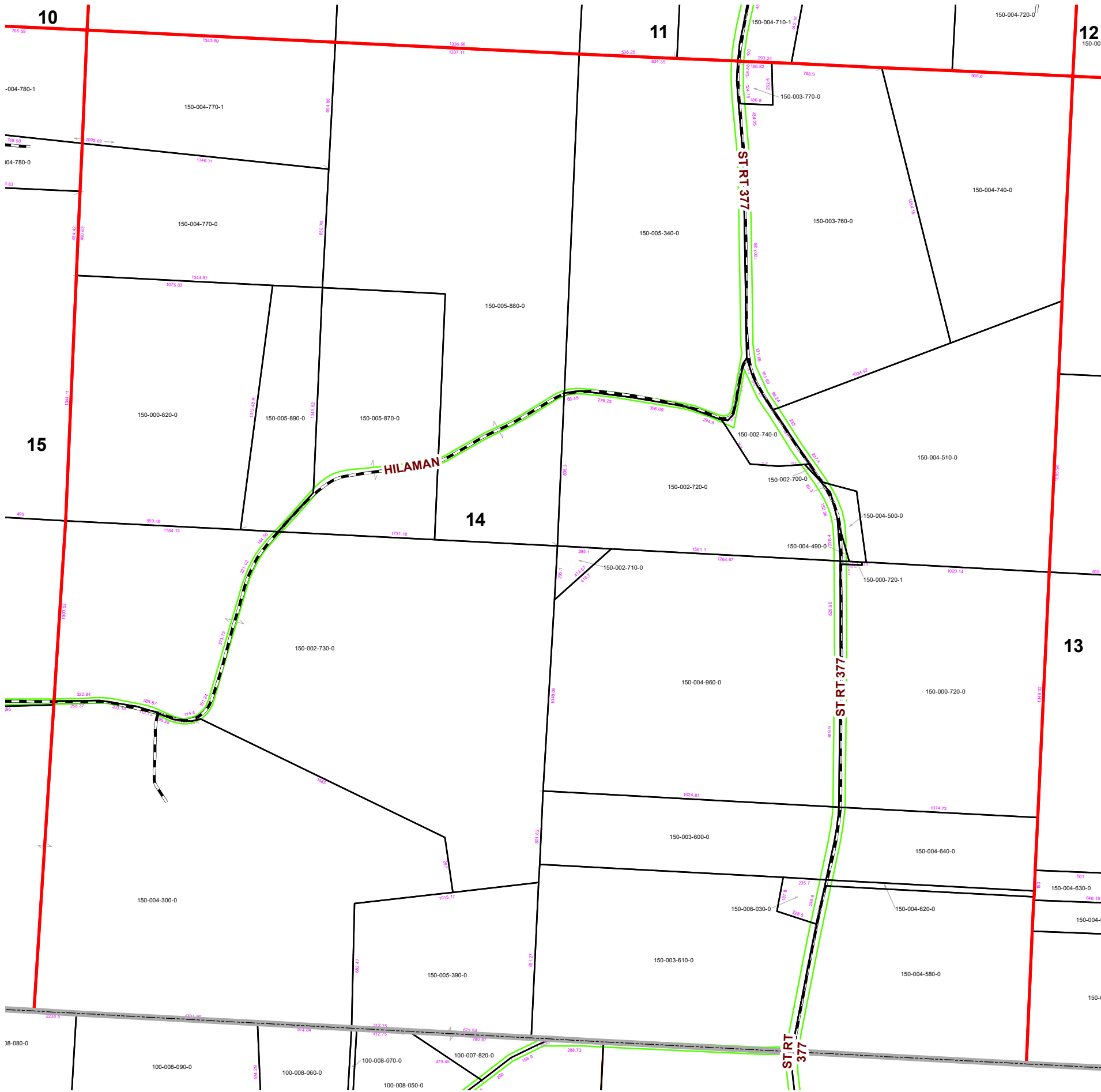

PIN	Owner	LegalDescr	Acres	VOL	PAGE	Survey_Ref
150-000-620-0	ACORN RIDGE LLC	R12 T09 S14 SD 4	31.062	OR211	173	PEN-0224.pdf
150-002-700-0	BRANNON JAMES B & KIMBERLY J	R12 T09 S14 SD 22 EX	0.024	OR218	786	NoSurvey.pdf
150-002-710-0	BRANNON JAMES B & KIMBERLY S	R12 T09 S14 SD 23	1	OR218	786	PEN-0294.pdf
150-002-720-0	BRANNON JAMES B & KIMBERLY S	R12 T09 S14 SD 18	24.729	OR218	786	PEN-0294.pdf
150-000-720-0	BURR DEBORAH DEBORAH BURR WA	R12 T09 S14 SD 6	34.058	D.V 168	221	PEN-0096.pdf
150-004-770-0	CONNOR KIMBERLY L & JASEN R UPC	R12 T09 S14 SD 3	21.26	OR226	1432	PEN-0296.pdf
150-002-730-0	DAWSON DAVID L & BERENICE J	R12 T09 S14 SD 15	82.37	D.V 187	194	PEN-0060.pdf
150-005-390-0	GAGE CHRISTOPHER DEVIN	R12 T09 S14 SD 16 SUR	17.5	OR232	3739	PEN-0139.pdf
150-000-720-1	HOOK STEVAN	R12 T09 S14 SD 30	0.047	OR203	673	PEN-0162.pdf
150-004-490-0	HOOK STEVAN	R12 T09 S14 SD 21	0.13	OR203	673	NoSurvey.pdf
150-004-500-0	HOOK STEVAN	R12 T09 S14 SD 20	1.15	OR203	673	NoSurvey.pdf
150-004-510-0	HOOK STEVAN	R12 T09 S14 SD 17	35.44	OR203	673	PEN-0096.pdf
150-002-740-0	JONAS GREGORY S	R12 T09 S14 SD 26	2.68	OR222	2006	PEN-0316.pdf
150-006-030-0	MATSON CARLOS W & CAROL J	R12 T09 S14 SD 24 SUR	1.153	OR146	579	PEN-0173.pdf
150-003-610-0	MATSON DAVID L & BONNIE L	R12 T09 S14 SD 7	31.43	D.V 136	209	PEN-0164.pdf
150-003-600-0	MATSON DAVID L & BONNIE L	R12 T09 S14 SD 12	14.64	D.V 136	209	NoSurvey.pdf
150-004-770-1	NEY ANDREW J & TERRY L	R12 T09 S14 SD 31 SUR	20.246	OR213	1860	PEN-0296.pdf
150-004-620-0	PIERPOINT DOROTHY B	R12 T09 S14 SD 14	0.86	OR202	780	NoSurvey.pdf
150-004-640-0	PIERPOINT DOROTHY B	R12 T09 S14 SD 25	9.91	OR202	780	NoSurvey.pdf
150-004-740-0	QUEEN EARL W	R12 T09 S14 SD 19	26.3	OR228	269	NoSurvey.pdf
150-004-960-0	ROLLI JERRY L & LINDA K	R12 T09 S14 SD 29	48.193	OR52	763	PEN-0033.pdf
150-004-300-0	SCHWARTZ ANDY L & KATIE J	R12 T09 S14 SD 5 SUR	65.909	OR230	973	PEN-0329.pdf
150-005-340-0	SIDWELL J TODD & KATHRYN A	R12 T09 S14 SD 28 EX	40.83	D.V 167	473	PEN-0029.pdf
150-004-580-0	TROIANO LARRY E & SUSAN A	R12 T09 S14 SD 13	23.47	OR21	215	NoSurvey.pdf
150-003-760-0	VAN NESS ROGER PAUL	R12 T09 S14 SD 1	34.527	OR222	2898	PEN-0210.pdf
150-003-770-0	VAN NESS ROGER PAUL	R12 T09 S14 SD 27	1.01	OR222	2898	PEN-0011.pdf
150-005-870-0	WADLEIGH DAVID H & SUSAN K	R12 T09 S14 SD 9-10	21.53	D.V 146	95	NoSurvey.pdf
150-005-890-0	WADLEIGH DAVID H & SUSAN K	R12 T09 S14 SD 11	10.33	D.V 146	95	NoSurvey.pdf
150-005-880-0	WADLEIGH DAVID H & SUSAN K	R12 T09 S14 SD 2	62.11	D.V 146	95	NoSurvey.pdf

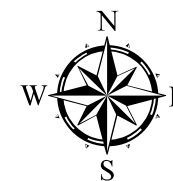

Boundaries			
	Hydro		Section
	Roads		Lot
	County		Township
	Parcel		ROW



Source: Morgan County Engineer's Office
 Author: Marcia Wolfe
 Date: 12/31/20

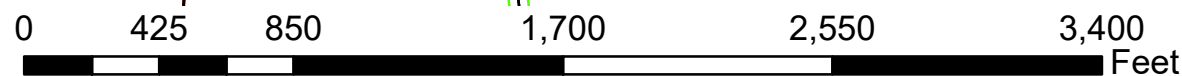

Disclaimer: The information that these maps contains is for reference purposes only. Please bring any errors to the attention of the Engineer's Office staff. Thank you